

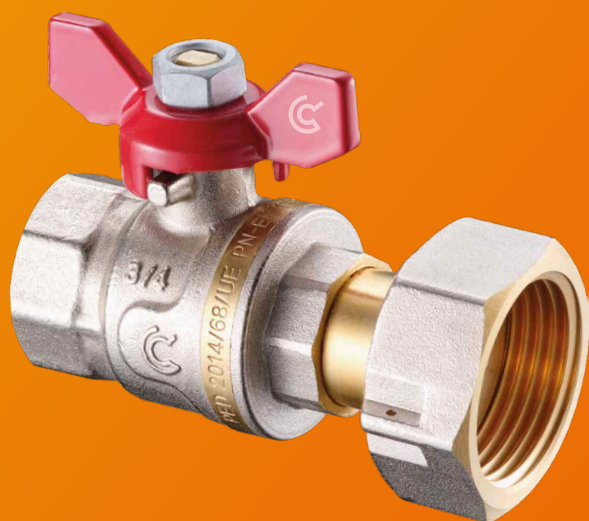

Ball valves
S40 PRO



Ball valves
S30



Ball valves
S30 N

Ball valves S40 PRO

BALL VALVES for drinking water

PURPOSE

Calido S40 Pro is a series of ball valves designed for the distribution of water intended for consumption, meeting the highest hygienic standards included in Directive (EU) 2020/2184 of the European Parliament and of the Council of 16 December 2020 on the quality of water intended for human consumption and in the Regulation of the Minister of Health of 7 December 2017 on the quality of water intended for human consumption. **Materials incorporated into the product comply with International standards.**

The valves can also be installed in heating systems (including those with glycol solution up to 40%), refrigeration, pneumatic and oil systems.

SECURITY SYSTEM

The design and assembly of the stem prevent being pushed out of the body due to sudden pressure increase in the system.

WORK PARAMETERS

Temperature range:
for liquids: -20°C (no freezing) to +150°C
pressure range:
for liquids: up to 40 bar



PROTECTION
CERTIFICATE

69947

PATENT
APPLICATION

P.434545

5 YEARS
WARRANTY

SEALS

Tightness (inner ball and outer stem) is guaranteed by PTFE seals. For increase safety, valve stems are equipped in a double seal:

- at the top of the stem traditional passive gland is used, with the possibility of additional sealing with a nut;
- at the bottom of the stem, modern dynamic sealing is applied in which the force of sealing increases with the increase in pressure between the ball and the body.

100% of valves are pneumatically tested for tightness.

DRIVE

The valves are equipped with levers made of stainless steel and plastic cover. The covers have a window - after the label is pulled out it is possible to describe, e.g. to which fixture we may close the flow with particular valve. Design of body and lever facilitates the change of lever mounting sides to make it easier when mounting the valve.

PRODUCT SIZES

Anti-lime ball valve F-F

Size range	Dimensions	A (mm)	B (mm)	C (mm)	D (mm)
CA/ZK-S40A-WWR15-OK	1/2"	49	119	62	94
CA/ZK-S40A-WWR20-OK	3/4"	56	122	69	94
CA/ZK-S40A-WWR25-OK	1"	64	146	81	114
CA/ZK-S40A-WWR32-OK	1 1/4"	76	151	90	114
CA/ZK-S40A-WWR40-OK	1 1/2"	87	199	102	155
CA/ZK-S40A-WWR50-OK	2"	102	207	118	155

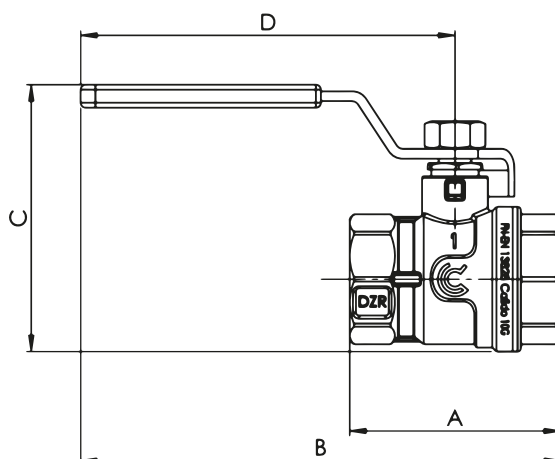

DZR
Brass

**RESISTANT
TO DEZINCIFICATION**



**MODERN DYNAMIC
SEALING**

PN40



**REINFORCED
BODY**



**FOR DRINKING
WATER**

DESIGN

The valve body is made of DZR brass resistant to dezincification, which eliminates the need of covering it with a layer of chrome or nickel, and the ball is covered with nanoceramics (anti-lime material). All materials used in the production of the valve are approved for contact with drinking water and glycol solution up to 40%.

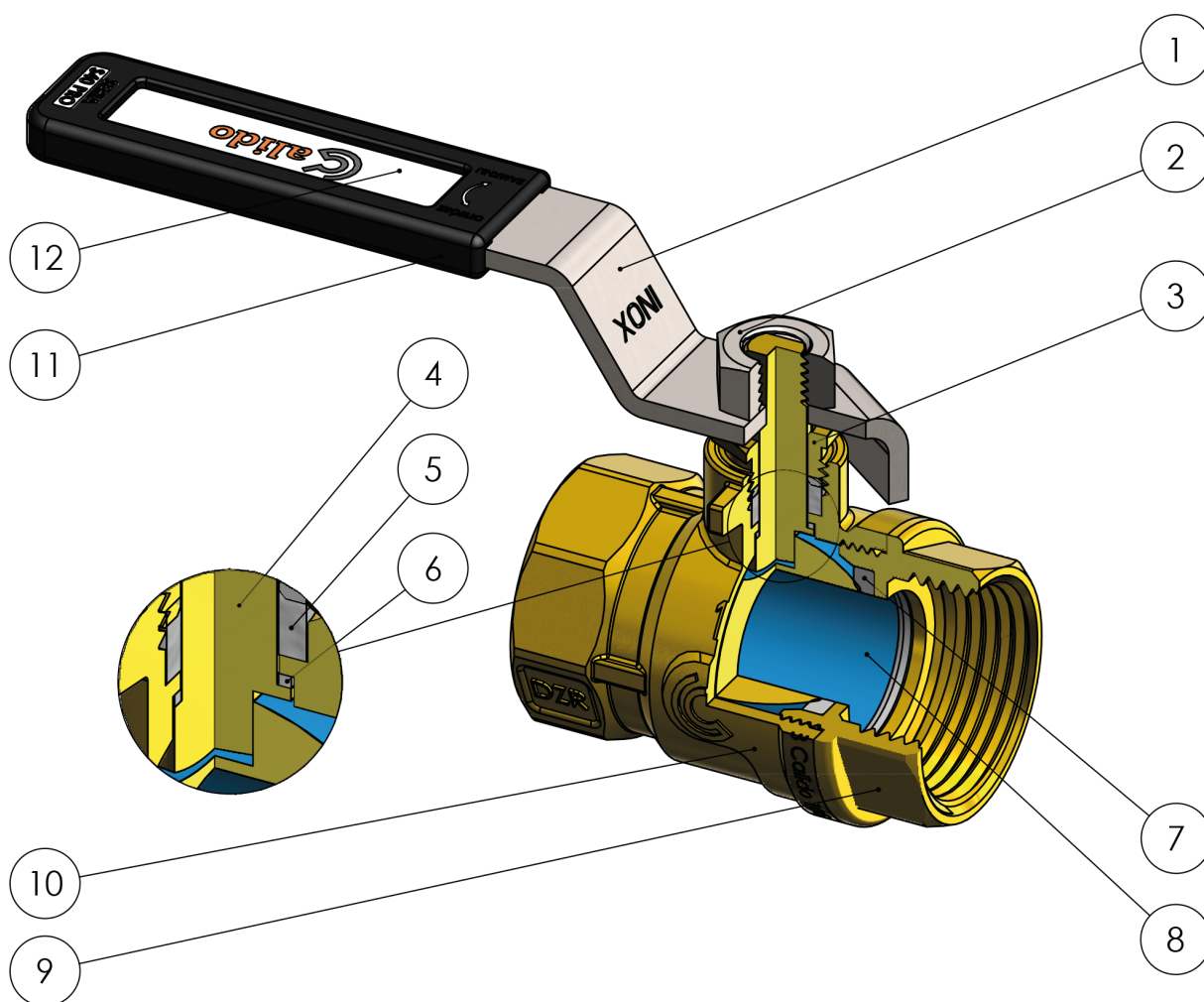

Lp	Description	Material	Finish surface
1	lever	stainless steel	brushed
2	lever nut	stainless steel	-
3	gland nut	brass CW614N	-
4	stem	brass CW614N	-
5	gland seal	PTFE teflon	-
6	stem seal	PTFE teflon	-

Lp	Description	Material	Finish surface
7	ball sealing	PTFE teflon	-
8	ball	brass CW617N	nanoceramics
9	side body	brass DZR	sandblasted
10	body	brass DZR	sandblasted
11	cover with a window	PE+EVA	-
12	label	PVC	-

S30 Ball valves

INTENDED PURPOSE

CALIDO S30 is a series of water ball valves, manually operated, aimed for installation in central heating systems, drinking water distribution systems, pneumatic and oil systems.

SEALING

Their tightness (internal - of the ball and external - of the stem) is guaranteed by sealing from PTFE. In order to increase safety of operation, valve stems are equipped with double sealing:

- at the top of the stem a traditional passive seal is applied, with a possibility of additional sealing with a nut,
- at the bottom of the stem there is a modern dynamic seal, in which the additional sealing force is increased along with the increase in pressure between the ball and the valve body.

TECHNICAL DATA

Scope of temperature for liquids: **-20°C (no freezing) up to 150°C**

Scope of pressure for liquids: **up to 30 bar**

Threads conforming to **PN-EN-ISO 228/1**.

All the materials used for valve production are authorised for contact with drinking water and glycol solution with concentration up to 40%.

CERTIFICATES AND GUARANTEES

It is a product with the attestation of the National Institute of Public Health - National Institute of Hygiene (NIZP-PZH). All valves meet the requirements of the EU Directive 2014/68/EU. National Declaration of Performance (KDWU) No. 5/calido/2022.

CE Certificate for the valves Calido of series S30 in sizes from 1 1/2" to 4". Positive National Technical Assessment (ITB-KOT-2020/1313 edition 3). 100% of valves are subjected to pneumatic leakage testing. Guarantee period for ball valves of Calido series S30 is 5 years from the date of purchase. The guarantee covers replacement or repair of the product along with the costs of these actions.

HANDLE

Valves are equipped with steel handles covered with anti-corrosive layer DACROMET and a plastic pad. Optionally, they are offered with an aluminium T-handle, which is powder coated.

The structure of the body and the handle allows to change the side of handle installation, depending on the needs.

SAFETY SYSTEMS

Construction and assembly of the stem prevent its pushing out of the valve body, as a result of sudden increase of pressure in the installation.

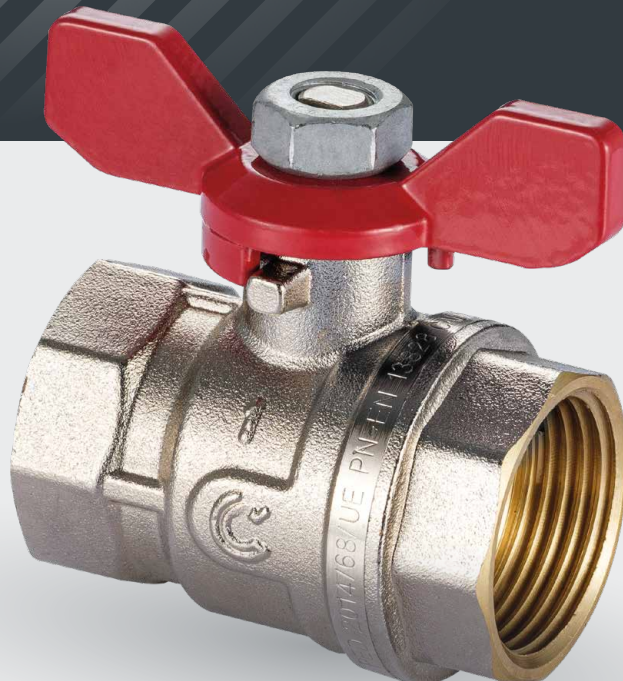

5 YEAR WARRANTY

**100% OF VALVES
SUBJECTED
TO LEAKAGE TEST**



Pressure / temperature chart

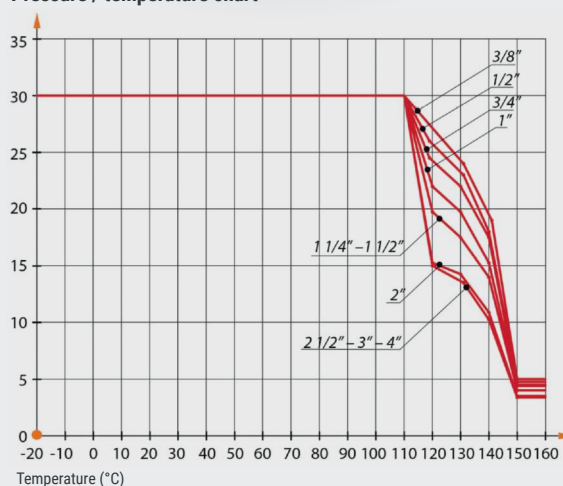

BALL VALVE F-F

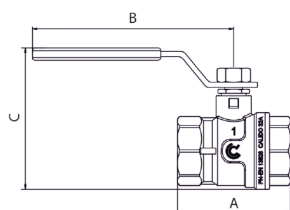

Code	Dimensions	A (mm)	B (mm)	C (mm)
CA/ZK-WWR08*	1/4"	41	70	49
CA/ZK-WWR10*	3/8"	41	70	49
CA/ZK-WWR15-OK**	1/2"	49	94	63
CA/ZK-WWR20-OK**	3/4"	56	94	70
CA/ZK-WWR25-OK**	1"	64	114	81
CA/ZK-WWR32-OK**	1 1/4"	76	114	91
CA/ZK-WWR40-OK	1 1/2"	87	154	104
CA/ZK-WWR50-OK	2"	102	154	118
CA/ZK-WWR65	2 1/2"	132	174	142
CA/ZK-WWR80	3"	152	238	168
CA/ZK-WWR100	4"	176	238	190

* standard handle (without a window)

** with red/blue handle (-N)

BALL VALVE F-M

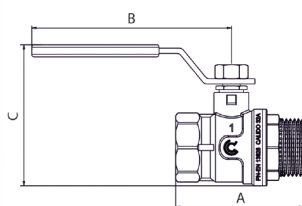

Code	Dimensions	A (mm)	B (mm)	C (mm)
CA/ZK-WZR15-OK*	1/2"	56	94	63
CA/ZK-WZR20-OK*	3/4"	64	94	70
CA/ZK-WZR25-OK*	1"	73	114	81
CA/ZK-WZR32-OK*	1 1/4"	85	114	90
CA/ZK-WZR40-OK	1 1/2"	98	154	104
CA/ZK-WZR50-OK	2"	119	154	118

* with red/blue handle (-N)

BALL VALVE F-F

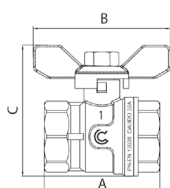

Code	Dimensions	A (mm)	B (mm)	C (mm)
CA/ZK-WWM10*	3/8"	41	54	46
CA/ZK-WWM15*	1/2"	49	54	54
CA/ZK-WWM20*	3/4"	56	54	61
CA/ZK-WWM25*	1"	64	75	73

* with red/blue T-handle (-N)

BALL VALVE F-F WITH SWIVEL NUT

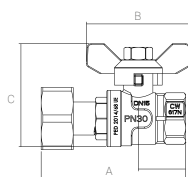

Code	Dimensions	A (mm)	B (mm)	C (mm)
CA/ZK-WWRNM15*	1/2"	72	53	53
CA/ZK-WWRNM20*	3/4"	79	53	61
CA/ZK-WWRNM25*	1"	73	75	90
CA/ZK-WWRNM32*	1 1/4"	83	75	109
CA/ZK-WWRNM1520*	1/2" x 3/4"	74	53	53
CA/ZK-WWRNM2025*	3/4" x 1"	84	53	61

* with red/blue T-handle (-N)

BALL VALVE F-M WITH SWIVEL NUT

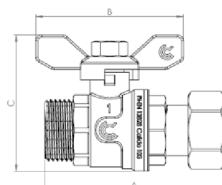

Code	Dimensions	A (mm)	B (mm)	C (mm)
CA/ZK-WZRNM15*	1/2"	72	54	54
CA/ZK-WZRNM20*	3/4"	81	54	61
CA/ZK-WZRNM25*	1"	91	75	73
CA/ZK-WZRNM32*	1 1/4"	83	75	111
CA/ZK-WZRNM1520*	1/2" x 3/4"	75	53	53
CA/ZK-WZRNM2025*	3/4" x 1"	85	53	61

* with red/blue T-handle (-N)

BALL VALVE F-M

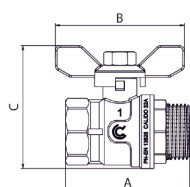

Code	Dimensions	A (mm)	B (mm)	C (mm)
CA/ZK-WZM15*	1/2"	56	54	54
CA/ZK-WZM20*	3/4"	64	54	61
CA/ZK-WZM25*	1"	73	75	73

* with red/blue T-handle (-N)

BALL VALVE M-M

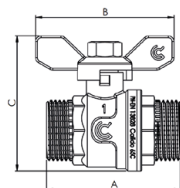

BALL VALVE F-M STRAIGHT, WITH HALF-UNION AND O-RING/WITHOUT O-RING

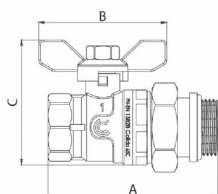

BALL VALVE F-M ANGLE, WITH HALF-UNION AND O-RING/WITHOUT O-RING

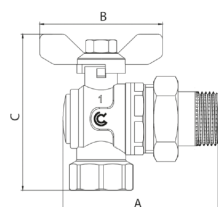

BALL VALVE F-F WITH FILTER / MAGNETIC FILTER

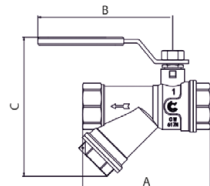

BALL VALVE F-F WITH FILTER

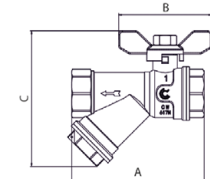

BALL VALVE F-F WITH DRAIN AND VENT

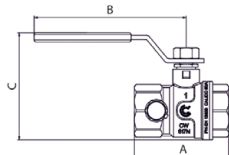

BALL VALVE F-M STRAIGHT, WITH HALF-UNION

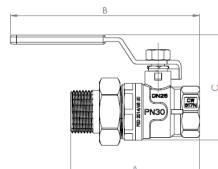

Code	Dimensions	A (mm)	B (mm)	C (mm)
CA/ZK-ZZM15*	1/2"	56	54	54
CA/ZK-ZZM20*	3/4"	64	54	61
CA/ZK-ZZM25*	1"	72	75	73

* with red/blue T-handle (-N)

Code	Dimensions	A (mm)	B (mm)	C (mm)
CA/ZK-WZPM15-O*	1/2" x 3/4" x 1/2"	81	54	56
CA/ZK-WZPM20-O*	3/4" x 1" x 3/4"	86	54	61
CA/ZK-WZPM25-O*	1" x 1 1/4" x 1"	102	75	72
CA/ZK-WZPM32-O*	1 1/4" x 1 1/2" x 1 1/4"	114	75	82
CA/ZK-WZPM15*	1/2" x 3/4" x 1/2"	78	54	56
CA/ZK-WZPM20*	3/4" x 1" x 3/4"	86	54	64
CA/ZK-WZPM25*	1" x 1 1/4" x 1"	102	75	77

* with red/blue T-handle (-N)

Code	Dimensions	A (mm)	B (mm)	C (mm)
CA/ZK-KWZPM15-O*	1/2" x 3/4" x 1/2"	75	54	71
CA/ZK-KWZPM20-O*	3/4" x 1" x 3/4"	81	54	80
CA/ZK-KWZPM25-O*	1" x 1 1/4" x 1"	93	75	95
CA/ZK-KWZPM15*	1/2" x 3/4" x 1/2"	76	54	75
CA/ZK-KWZPM20*	3/4" x 1" x 3/4"	86	54	84
CA/ZK-KWZPM25*	1" x 1 1/4" x 1"	91	75	95

* with red/blue T-handle (-N)

Code	Dimensions	A (mm)	B (mm)	C (mm)
CA/ZK-WWFR15*	1/2"	78	91	94
CA/ZK-WWFR20*	3/4"	96	102	94
CA/ZK-WWFR25*	1"	108	120	119
CA/ZK-WWFR15**	1/2"	81	94	89
CA/ZK-WWFR20**	3/4"	98	94	100
CA/ZK-WWFR25**	1"	110	114	116

* with red/blue handle (-N)

** with magnetic filter and red/blue handle (-N)

Code	Dimensions	A (mm)	B (mm)	C (mm)
CA/ZK-WWFM15*	1/2"	78	54	81
CA/ZK-WWFM20*	3/4"	96	54	93
CA/ZK-WWFM25*	1"	108	75	110

* with red/blue T-handle(-N)

Code	Dimensions	A (mm)	B (mm)	C (mm)
CA/ZK-WWSOR15*	1/2"	56	94	63
CA/ZK-WWSOR20*	3/4"	65	94	70
CA/ZK-WWSOR25*	1"	71	114	81

* with red/blue handle (-N)

Code	Dimensions	A (mm)	B (mm)	C (mm)
CA/ZK-WZPR15-OK*	1/2"x3/4"x1/2"	78	118	62
CA/ZK-WZPR20-OK*	3/4"x1"x3/4"	87	122	69
CA/ZK-WZPR25-OK*	1x1 1/4"x1"	99	146	81

** with red/blue handle (-N)

BALL VALVE F-F WITH SWIVEL NUT 1" WITH RED OR BLUE KNOB AND THERMOMETER



Code	Dimensions	A (mm)	B (mm)	C (mm)
CA/ZK-WWRNT25-CZ	1"	90	73	88
CA/ZK-WWRNT25-N	1"	90	73	88

MINI SERIES

BALL VALVES MINI S30



Code	Dimensions	A (mm)	B (mm)	C (mm)
CA/ZK-MINI1/2CZ	1/2"	48	45	33
CA/ZK-MINI1/2N	1/2"	48	45	33

T work=110°C, PN 30 bar.

BALL VALVES MINI S30 FOR PEX 16 x 2.0 PIPES



Code	Dimensions	A (mm)	B (mm)	C (mm)
CA/ZK-MINI1/2X16CZ	1/2"x16x2,0	58	33	44
CA/ZK-MINI1/2X16N	1/2"x16x2,0	58	33	44

T work 95°C, PN 30 bar, PEX connector: T work 95°C, PN 10 bar

DRAIN VALVE M WITH A SEALING RING, LOCKNUT, PLUG AND HOSE CONNECTOR



Code	Dimensions	A (mm)	B (mm)	C (mm)
CA/ZKS-15	1/2"	68	40	43
CA/ZKS-20	3/4"	74	40	43
CA/ZKS-PN15*	1/2"	72	40	43

*Tmax=110°C, PN 25 bar.

PLUGS WITH BALL VALVES

55/60 CONTAINER PLUG
WITH A CALIDO BALL VALVE 3/4"
AND A QUICK-COUPLING

Code: CA/ZK-KOREK WZR20

Tmax 90°C, PN 30 bar

55/60 CONTAINER PLUG
WITH A CALIDO BALL VALVE 1"
FROM THE S30 SERIES

Code: CA/ZK-KOREK WZR25



Ball valves S30 N

PURPOSE

Calido S30N is a series of water ball valves, manually operated, aimed for installation in central heating systems, distribution systems, pneumatic and oil systems.

DOUBLE SEALING

Their tightness (internal - of the ball and external - of the stem) is guaranteed by sealing from PTFE. In order to increase safety of operation, valve stems are equipped with double sealing: at the top of the stem a traditional passive seal is applied, with a possibility of additional sealing with a nut. at the bottom of the stem there is a modern dynamic seal, in which the additional sealing force is increased along with the increase in pressure between the ball and the valve body.

TECHNICAL DATA

Scope of temperature for liquids **-20°C (no freezing) up to 150°C**
Scope of pressure for liquids: **up to 30 bar**
Threads conforming to **PN-EN-ISO 228/1**.
All the materials used for valve production are authorised for contact with glycol solution with concentration up to 40 %.

CERTIFICATES AND GUARANTEES

All valves meet the requirements of the EU Directive PED 2014/68/UE.
CE Certificate for CALIDO S30 valves in sizes: 1 1/2 to 4.
National Technical Assessment ITB KOT 2020/1313 edition 3.
National declaration of performance No2/calido/2024.
Protection certificate for a utility model no 69947.

SAFETY SYSTEMS

The design and assembly of the stem prevent it from being pushed out of the body due to a sudden pressure increase in the system.

HANDLE

Valves are equipped with steel handles with plastic covers. They have a window and a label that allows for description, e.g. to which device we can cut off the flow with a given valve.



**PROTECTION
CERTIFICATE**

69947

5 YEARS WARRANTY

**100% OF VALVES
TESTED
FOR TIGHTNESS**

Graph Pressure/Temperature

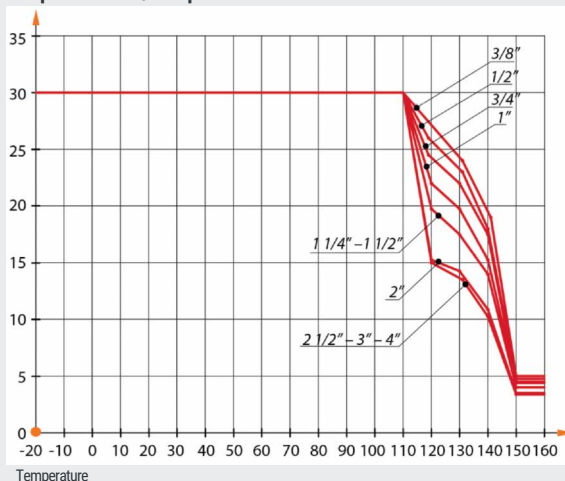

VALVE GW/GW, HANDLE

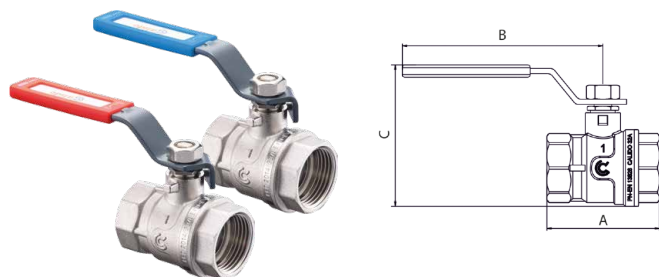

Code	Dimensions	A (mm)	B (mm)	C (mm)
CA/ZKN-WWR10*	3/8"	41	70	49
CA/ZKN-WWR15*	1/2"	49	94	63
CA/ZKN-WWR20*	3/4"	56	94	70
CA/ZKN-WWR25*	1"	64	114	81
CA/ZKN-WWR32*	1 1/4"	76	114	91
CA/ZKN-WWR40	1 1/2"	87	154	104
CA/ZKN-WWR50	2"	102	154	118

* Available with red or blue handle (-N)

VALVEGW/GZ, HANDLE

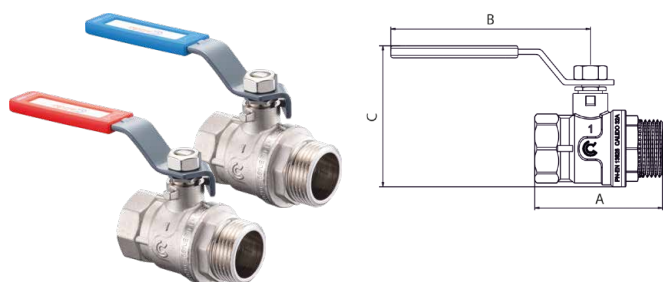

Code	Dimensions	A (mm)	B (mm)	C (mm)
CA/ZKN-WZR15*	1/2"	56	94	63
CA/ZKN-WZR20*	3/4"	64	94	70
CA/ZKN-WZR25*	1"	73	114	81
CA/ZKN-WZR32*	1 1/4"	85	114	90
CA/ZKN-WZR40	1 1/2"	98	154	104
CA/ZKN-WZR50	2"	119	154	118

* Available with red or blue handle (-N)

VALVE GW/GW, WITH SWIVEL NUT



Code	Dimensions	A (mm)	B (mm)	C (mm)
CA/ZKN-WWM10*	3/8"	41	54	46
CA/ZKN-WWM15*	1/2"	49	54	54
CA/ZKN-WWM20*	3/4"	56	54	61
CA/ZKN-WWM25*	1"	64	75	73

* Available with red or blue swivel nut (-N)

VALVE GW/GZ, WITH SWIVEL NUT



Code	Dimensions	A (mm)	B (mm)	C (mm)
CA/ZKN-WZM15*	1/2"	56	54	54
CA/ZKN-WZM20*	3/4"	64	54	61
CA/ZKN-WZM25*	1"	73	75	73

* Available with red or blue swivel nut (-N)

VALVE GW/GZ WITH HALF-UNION, WITH SWIVEL NUT



Code	Dimensions	A (mm)	B (mm)	C (mm)
CA/ZKN-WZPM15*	1/2" x 3/4" x 1/2"	78	54	56
CA/ZKN-WZPM20*	3/4" x 1" x 3/4"	87	54	64
CA/ZKN-WZPM25*	1" x 1 1/4" x 1"	99	75	77

* Available with red or blue swivel nut (-N)

VALVE GW/GZ WITH HALF-UNION AND O-RING, SWIVEL NUT



Code	Dimensions	A (mm)	B (mm)	C (mm)
CA/ZKN-WZPM15-0*	1/2" x 3/4" x 1/2"	81	54	56
CA/ZKN-WZPM20-0*	3/4" x 1" x 3/4"	86	54	61
CA/ZKN-WZPM25-0*	1" x 1 1/4" x 1"	102	75	72
CA/ZKN-WZPM32-0*	1 1/4" x 1 1/2" x 1 1/4"	114	75	82

* Available with red or blue swivel nut (-N)

VALVE GW/GZ WITH HALF-UNION, SWIVEL NUT

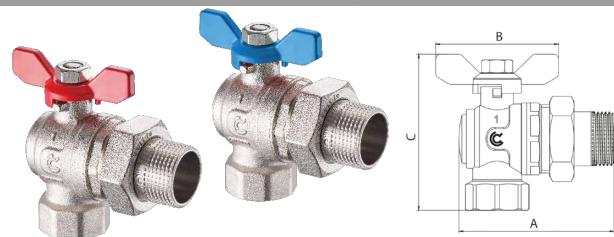

Code	Dimensions	A (mm)	B (mm)	C (mm)
CA/ZKN-KWZPM15*	1/2" x 3/4" x 1/2"	76	54	75
CA/ZKN-KWZPM20*	3/4" x 1" x 3/4"	86	54	84
CA/ZKN-KWZPM25*	1" x 1 1/4" x 1"	91	75	95

* Available with red or blue swivel nut (-N)

ANGLE VALVE GW/GZ WITH HALF-UNION AND O-RING, SWIVEL NUT



Code	Dimensions	A (mm)	B (mm)	C (mm)
CA/ZKN-KWZPM15-0*	1/2" x 3/4" x 1/2"	75	54	71
CA/ZKN-KWZPM20-0*	3/4" x 1" x 3/4"	81	54	80
CA/ZKN-KWZPM25-0*	1" x 1 1/4" x 1"	93	75	95

* Available with red or blue swivel nut (-N)

VALVE GW/GW WITH FILTER, HANDLE

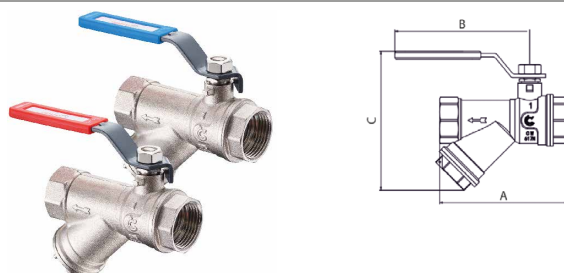

Code	Dimensions	A (mm)	B (mm)	C (mm)
CA/ZKN-WWFR15*	1/2"	78	91	94
CA/ZKN-WWFR20*	3/4"	96	102	94
CA/ZKN-WWFR25*	1"	108	120	119

* Available with red or blue swivel nut (-N)

BALL VALVE GW/GW WITH SWIVEL NUT, THERMOMETER AND KNOB

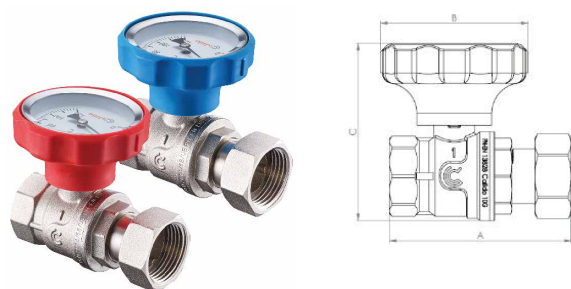

Code	Dimensions	A (mm)	B (mm)	C (mm)
CA/ZKN-WWRNT25-CZ	1"	90	73	88
CA/ZKN-WWRNT25-N	1"	90	73	88

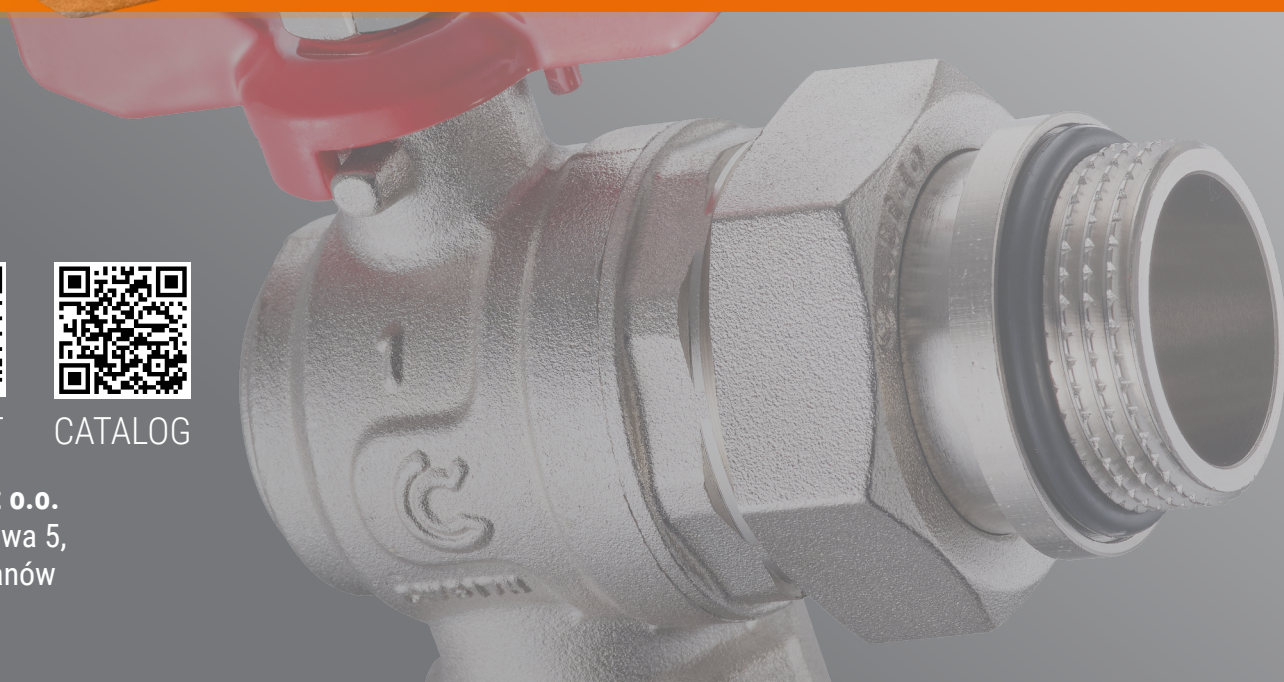
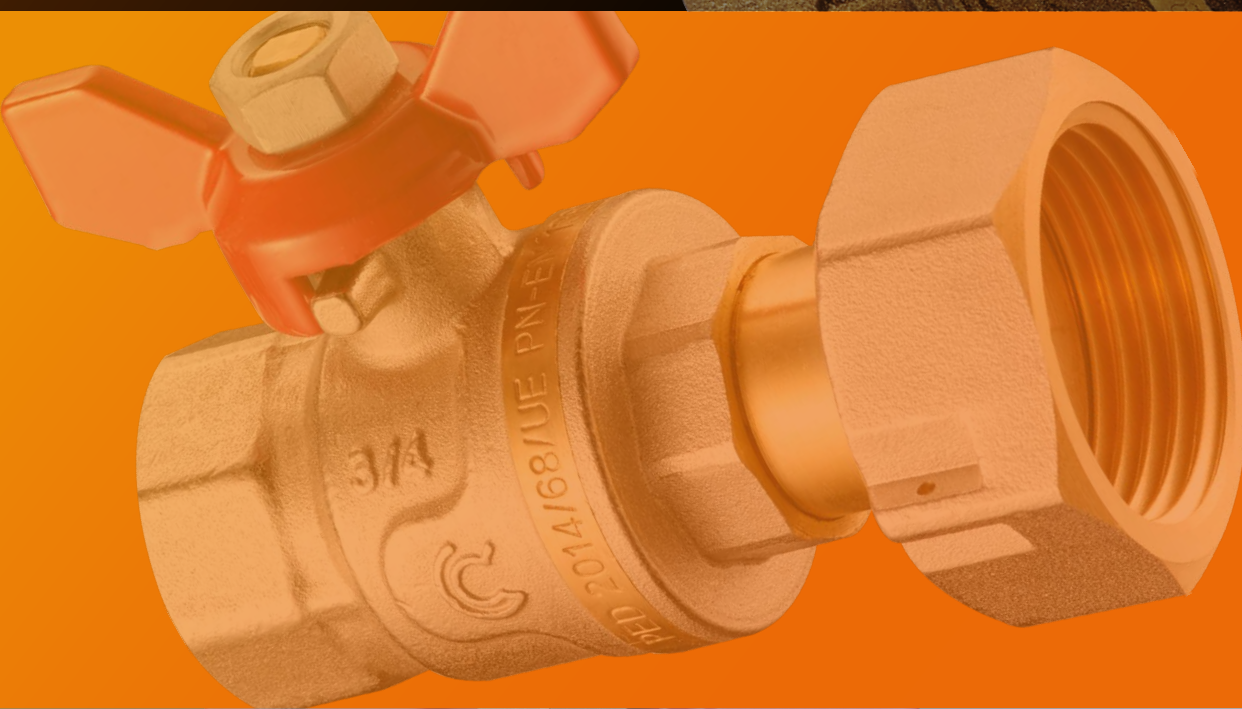

LEAFLET



CATALOG

Arka Sp. z o.o.
ul. Ogrodowa 5,
76-004 Sianów
Poland